

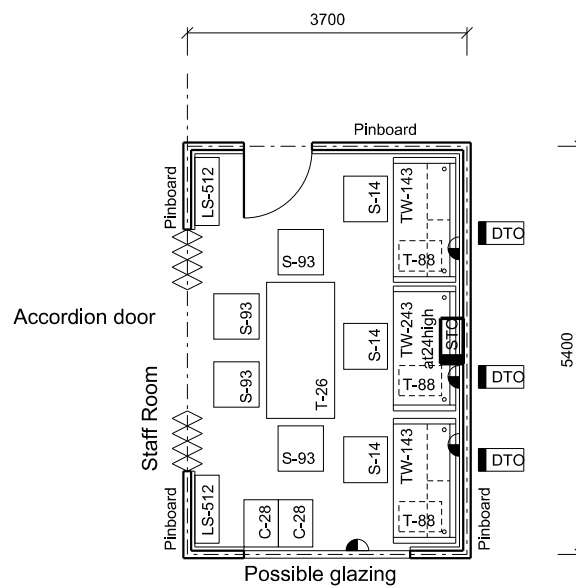

SCHOOL TYPE  
KEY LEARNING / SUPPORT AREA  
ROOM / SPACE  
TYPE / ID

Schools for Specific Purposes  
Staff Unit  
Staff Room Annexe  
Type 2 - SSP602.22

SCHEDULE AREA 19m<sup>2</sup>



Floor Area shown 19.08 sq.m

#### FURNITURE

ID	QUANTITY
C-28	2
LS-512	2
S-14	3
S-93	4
T-26	1
T-88	3
TW-143	2
TW-243	1

Furniture quantities are indicative and are related to the floor plan indicated. Actual furniture selection and quantities will be dependent on the approved design, specific school needs, student ages, student capabilities and their teachers.

1:100 @ A4 0 1 2 3 4m

REVISION DATE  
19 DECEMBER 2013

The information on this sheet once printed/exported is classed as an uncontrolled copy.  
The currency of the information should be checked by visiting the EFSG website prior to using the information for any purposes.