



| SCHOOL TYPE | KEY LEARNING / SUPPORT AREA | ROOM / SPACE | TYPE / ID |
|-------------|-----------------------------|---------------|-----------|
| Primary | Mathematics | Classroom | 101 |
| Primary | Science | Lab | 202 |
| Primary | English | Classroom | 303 |
| Primary | Art | Studio | 404 |
| Primary | Music | Room | 505 |
| Primary | Physical Education | Gymnasium | 606 |
| Primary | Library | Reading Room | 707 |
| Primary | Computer Science | IT Lab | 808 |
| Primary | Foreign Language | Classroom | 909 |
| Primary | Special Education | Resource Room | 1010 |
| Primary | Health Education | Health Room | 1111 |
| Primary | Environmental Studies | Classroom | 1212 |
| Primary | History | Classroom | 1313 |
| Primary | Geography | Classroom | 1414 |
| Primary | Social Studies | Classroom | 1515 |
| Primary | Character Education | Classroom | 1616 |
| Primary | Life Skills | Classroom | 1717 |
| Primary | Career Education | Classroom | 1818 |
| Primary | Financial Literacy | Classroom | 1919 |
| Primary | Entrepreneurship | Classroom | 2020 |
| Primary | Leadership | Classroom | 2121 |
| Primary | Public Speaking | Classroom | 2222 |
| Primary | Team Building | Classroom | 2323 |
| Primary | Conflict Resolution | Classroom | 2424 |
| Primary | Emotional Regulation | Classroom | 2525 |
| Primary | Self-awareness | Classroom | 2626 |
| Primary | Empathy | Classroom | 2727 |
| Primary | Resilience | Classroom | 2828 |
| Primary | Stress Management | Classroom | 2929 |
| Primary | Time Management | Classroom | 3030 |
| Primary | Organization | Classroom | 3131 |
| Primary | Planning | Classroom | 3232 |
| Primary | Problem Solving | Classroom | 3333 |
| Primary | Decision Making | Classroom | 3434 |
| Primary | Goal Setting | Classroom | 3535 |
| Primary | Self-reflection | Classroom | 3636 |
| Primary | Peer Review | Classroom | 3737 |
| Primary | Self-evaluation | Classroom | 3838 |
| Primary | Feedback | Classroom | 3939 |
| Primary | Self-improvement | Classroom | 4040 |
| Primary | Personal Growth | Classroom | 4141 |
| Primary | Self-awareness | Classroom | 4242 |
| Primary | Empathy | Classroom | 4343 |
| Primary | Resilience | Classroom | 4444 |
| Primary | Stress Management | Classroom | 4545 |
| Primary | Time Management | Classroom | 4646 |
| Primary | Organization | Classroom | 4747 |
| Primary | Planning | Classroom | 4848 |
| Primary | Problem Solving | Classroom | 4949 |
| Primary | Decision Making | Classroom | 5050 |
| Primary | Goal Setting | Classroom | 5151 |
| Primary | Self-reflection | Classroom | 5252 |
| Primary | Peer Review | Classroom | 5353 |
| Primary | Self-evaluation | Classroom | 5454 |
| Primary | Feedback | Classroom | 5555 |
| Primary | Self-improvement | Classroom | 5656 |
| Primary | Personal Growth | Classroom | 5757 |
| Primary | Self-awareness | Classroom | 5858 |
| Primary | Empathy | Classroom | 5959 |
| Primary | Resilience | Classroom | 6060 |
| Primary | Stress Management | Classroom | 6161 |
| Primary | Time Management | Classroom | 6262 |
| Primary | Organization | Classroom | 6363 |
| Primary | Planning | Classroom | 6464 |
| Primary | Problem Solving | Classroom | 6565 |
| Primary | Decision Making | Classroom | 6666 |
| Primary | Goal Setting | Classroom | 6767 |
| Primary | Self-reflection | Classroom | 6868 |
| Primary | Peer Review | Classroom | 6969 |
| Primary | Self-evaluation | Classroom | 7070 |
| Primary | Feedback | Classroom | 7171 |
| Primary | Self-improvement | Classroom | 7272 |
| Primary | Personal Growth | Classroom | 7373 |
| Primary | Self-awareness | Classroom | 7474 |
| Primary | Empathy | Classroom | 7575 |
| Primary | Resilience | Classroom | 7676 |
| Primary | Stress Management | Classroom | 7777 |
| Primary | Time Management | Classroom | 7878 |
| Primary | Organization | Classroom | 7979 |
| Primary | Planning | Classroom | 8080 |
| Primary | Problem Solving | Classroom | 8181 |
| Primary | Decision Making | Classroom | 8282 |
| Primary | Goal Setting | Classroom | 8383 |
| Primary | Self-reflection | Classroom | 8484 |
| Primary | Peer Review | Classroom | 8585 |
| Primary | Self-evaluation | Classroom | 8686 |
| Primary | Feedback | Classroom | 8787 |
| Primary | Self-improvement | Classroom | 8888 |
| Primary | Personal Growth | Classroom | 8989 |
| Primary | Self-awareness | Classroom | 9090 |
| Primary | Empathy | Classroom | 9191 |
| Primary | Resilience | Classroom | 9292 |
| Primary | Stress Management | Classroom | 9393 |
| Primary | Time Management | Classroom | 9494 |
| Primary | Organization | Classroom | 9595 |
| Primary | Planning | Classroom | 9696 |
| Primary | Problem Solving | Classroom | 9797 |
| Primary | Decision Making | Classroom | 9898 |
| Primary | Goal Setting | Classroom | 9999 |
| Primary | Self-reflection | Classroom | 10000 |
| Primary | Peer Review | Classroom | |

Schools for Specific Purposes
Administration Unit
Administration - Clerical
Type 3 - SSP601.23

SCHEDULE AREA 53m²

| FIXTURES | QUANTITY |
|--------------|----------|
| SAFE | 1 |
| RECEPTION | 1 |
| COUNTER | |
| WORKBENCH | 1 |
| & FRAME | |
| MSS-400/300A | |

| FURNITURE | |
|-----------|----------|
| ID | QUANTITY |
| B-33 | 1 |
| B-36L | 1 |
| B-36R | 2 |
| B-53 | 2 |
| C-26 | 1 |
| C-29 | 3 |
| D-05 | 2 |
| L-04 | 1 |
| LS-793 | 1 |
| S-14 | 3 |
| S-32 | 1 |
| S-34 | 1 |
| SW-206 | 1* |
| SW-208 | 1* |
| SW-405 | 1* |
| SW-932 | 2 |
| T-60 | 2 |
| T-88 | 3 |

Furniture quantities are indicative and are related to the floor plan indicated. Actual furniture selection and quantities will be dependent on the approved design, specific school needs, student ages, student capabilities and their teachers.

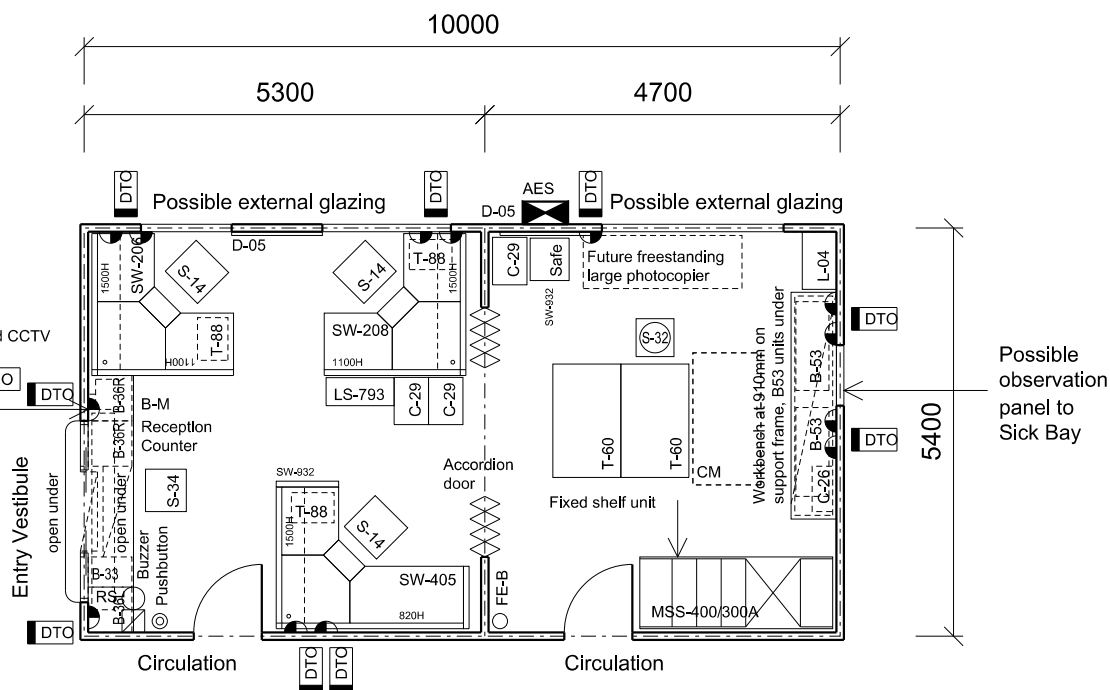

Floor Area shown 52.47 sq.m

1:100 @ A4

REVISION DATE
02 MAY 2014

The information on this sheet once printed/exported is classed as an uncontrolled copy.
The currency of the information should be checked by visiting the EFGS website prior to using the information for any purposes.