



SCHOOL TYPE
KEY LEARNING / SUPPORT AREA
ROOM / SPACE
TYPE / ID

Schools for Specific Purposes
Special Programs Unit
Kitchenette
Type 2 - SSP502.16

SCHEDULE AREA 20m²

NOTES

- 1 Proportion of room important -for specialist spaces.
- 2 Careful selection of furniture to meet needs is required.
- 3 FE-B to be located in closet lockable store.

FIXTURES

ID	QUANTITY
BS	1
ES	1
TR	1
DW	1

FURNITURE

ID	QUANTITY
B-00	1
B-121	1
B-122	1
B-126	1
B-27L	1
B-34	1
B-47L	1
M-202	1
M-75	1
M-79	1
SK-41	1
Sp-00	*
Sp-01	*
Sp-02	*
Sp-49	*

* To be selected according to the user group characteristics. Selections to be confirmed by project control group

Furniture quantities are indicative and are related to the floor plan indicated. Actual furniture selection and quantities will be dependent on the approved design, specific school needs, student ages, student capabilities and their teachers.

REVISION DATE
02 MAY 2014

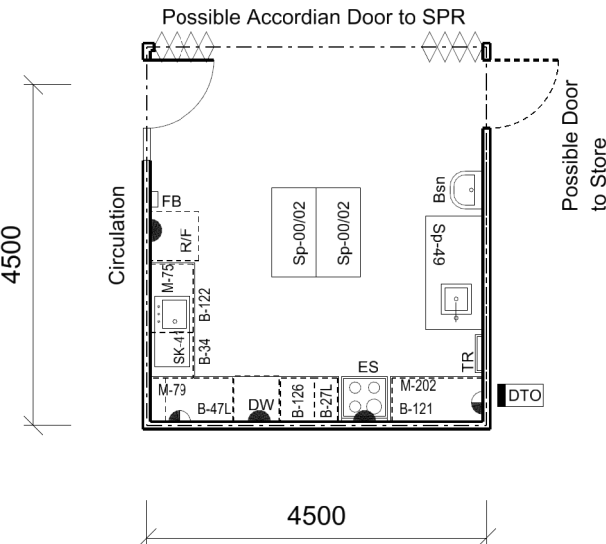

Floor Area shown 21.5 sq.m

1:100 @ A4 0 1 2 3 4m

The information on this sheet once printed/exported is classed as an uncontrolled copy.
The currency of the information should be checked by visiting the EFSG website prior to using the information for any purposes.