



SCHOOL TYPE
KEY LEARNING / SUPPORT AREA
ROOM / SPACE
TYPE / ID

Primary
Canteen
Canteen
Type 2 - PS604.02

SCHEDULE AREA 27m²

NOTES

- 1 Due to the specific functional requirements of this space it is assumed that the space is not accessible to mobility impaired persons
- 2 For Core 14

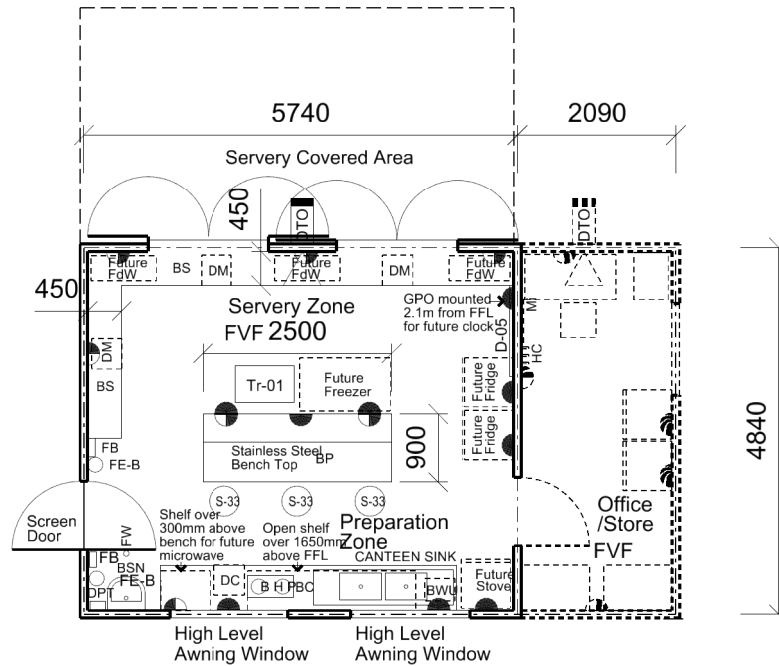

Floor Area shown 26.73 sq.m & 9.43 sq.m

FIXTURES

ID	QUANTITY
BHP	1
BSN	1
CS	1
WIRE	1
BASKET	
DPT	1
BWU	1
BS	1
BC	1
BP	1
DM	3
DC	1

FURNITURE

ID	QUANTITY
C-28	1
D-05	1
S-32	3
S-40	1
T-19	1
Tr-01	1

Furniture quantities are indicative and are related to the floor plan indicated. Actual furniture selection and quantities will be dependent on the approved design, specific school needs, student ages, student capabilities and their teachers.

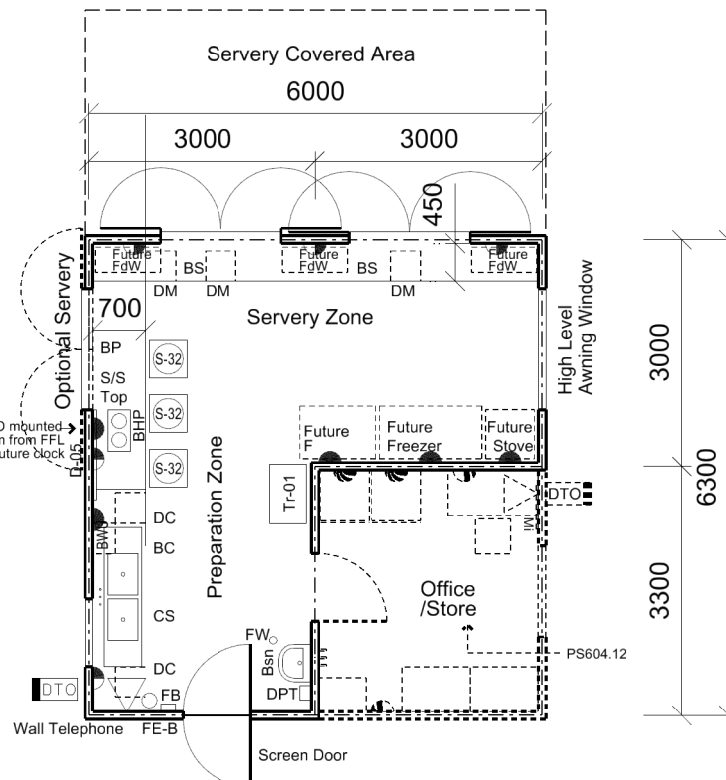

Floor Area shown 26.68 sq.m & 9.28 sq.m

1:100 @ A4 0 1 2 3 4m

REVISION DATE
7 NOVEMBER 2013

The information on this sheet once printed/exported is classed as an uncontrolled copy.
The currency of the information should be checked by visiting the EFSG website prior to using the information for any purposes.