



SCHOOL TYPE
KEY LEARNING / SUPPORT AREA
ROOM / SPACE
TYPE / ID

Primary
Administration Unit
Principal / Meeting Room
Type 2 - PS601.12

SCHEDULE AREA 17m²

NOTES

1 For Core 14/21

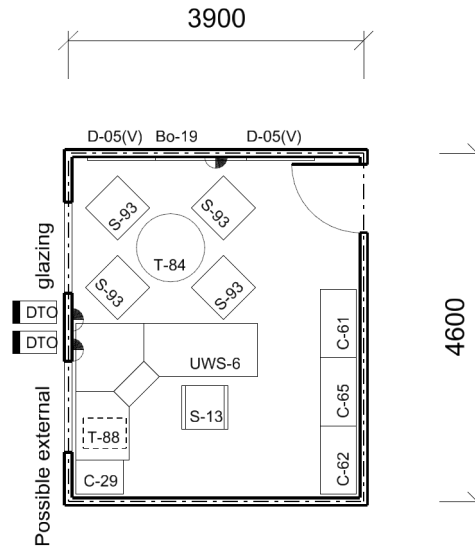

Floor Area shown 17.1 sq.m

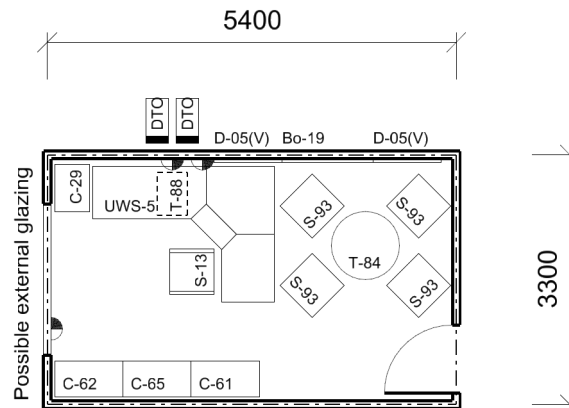

Floor Area shown 16.96 sq.m

FURNITURE

ID	QUANTITY
Bo-19	1
C-29	1
C-61	1
C-62	1
C-65	1
D-05	2
S-13	1
S-93	4
T-84	1
T-88	1
UWS-6	1*

* To be selected according to the user group characteristics. Selections to be confirmed by project control group

Furniture quantities are indicative and are related to the floor plan indicated. Actual furniture selection and quantities will be dependent on the approved design, specific school needs, student ages, student capabilities and their teachers.

1:100 @ A4 0 1 2 3 4m

REVISION DATE
28 OCTOBER 2013

The information on this sheet once printed/exported is classed as an uncontrolled copy.
The currency of the information should be checked by visiting the EFSG website prior to using the information for any purposes.