



SCHOOL TYPE  
KEY LEARNING / SUPPORT AREA  
ROOM / SPACE  
TYPE / ID

Primary  
Administration Unit  
Entry Vestibule  
Type 3 - PS601.03

SCHEDULE AREA 13m<sup>2</sup>

#### NOTES

1 For Core 14

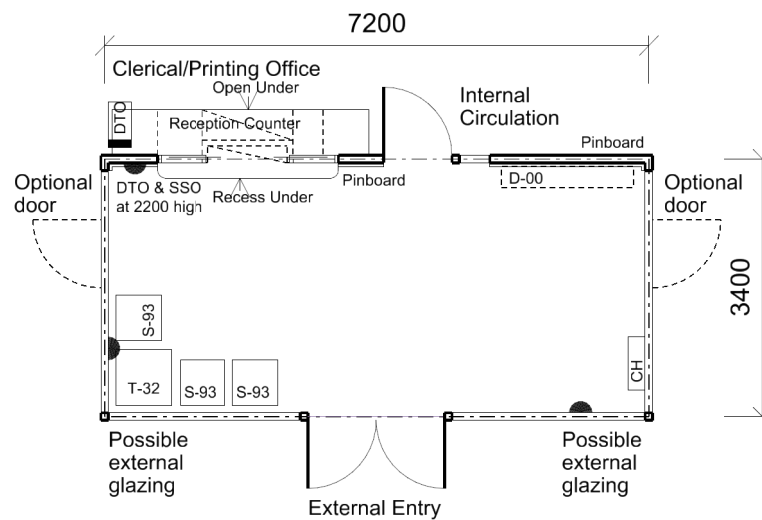

Floor Area shown 23.4 sq.m (including Circulation)

#### FIXTURES

ID	QUANTITY
RECEPTION COUNTER	1

#### FURNITURE

ID	QUANTITY
D-00	1
S-93	3
T-32	1

Furniture quantities are indicative and are related to the floor plan indicated. Actual furniture selection and quantities will be dependent on the approved design, specific school needs, student ages, student capabilities and their teachers.

1:100 @ A4 0 1 2 3 4m

REVISION DATE  
28 OCTOBER 2013

The information on this sheet once printed/exported is classed as an uncontrolled copy.  
The currency of the information should be checked by visiting the EFSG website prior to using the information for any purposes.