



SCHOOL TYPE
KEY LEARNING / SUPPORT AREA
ROOM / SPACE
TYPE / ID

Primary
Administration Unit
Entry Vestibule
Type 2 - PS601.02

SCHEDULE AREA 9m²

NOTES

1 For Core 7

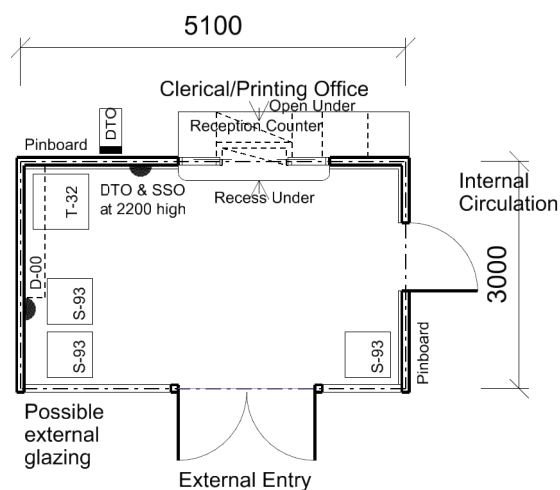

Floor Area shown 14.5 sq.m (including Circulation)

FIXTURES

ID	QUANTITY
----	----------

RECEPTION 1
COUNTER

FURNITURE

ID	QUANTITY
----	----------

D-00	1
S-93	3
T-32	1

Furniture quantities are indicative and are related to the floor plan indicated. Actual furniture selection and quantities will be dependent on the approved design, specific school needs, student ages, student capabilities and their teachers.

1:100 @ A4 

REVISION DATE
28 OCTOBER 2013

The information on this sheet once printed/exported is classed as an uncontrolled copy.
The currency of the information should be checked by visiting the EFGS website prior to using the information for any purposes.