

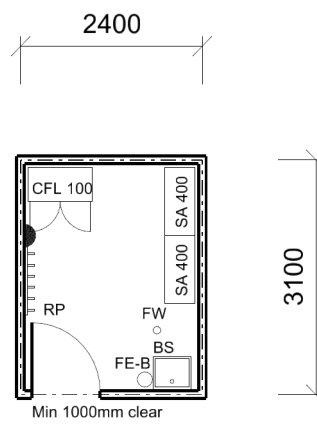

SCHOOL TYPE
KEY LEARNING / SUPPORT AREA
ROOM / SPACE
TYPE / ID

Secondary
Storage Unit
Cleaning Supplies Store Room
HS605.05

SCHEDULE AREA 7m²



Floor Area shown 6.9 sq.m

FIXTURES

ID	QUANTITY
SA 600	2
BS	1
RP	1
CFL	1 (100L)

1:100 @ A4 0 1 2 3 4m

REVISION DATE
12 DECEMBER 2013

The information on this sheet once printed/exported is classed as an uncontrolled copy.
The currency of the information should be checked by visiting the EFSG website prior to using the information for any purposes.