

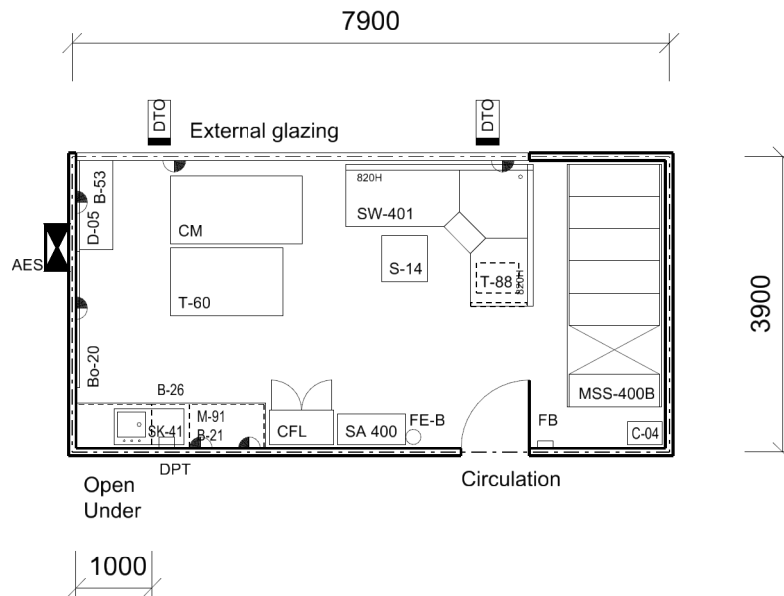

**SCHOOL TYPE**  
**KEY LEARNING / SUPPORT AREA**  
**ROOM / SPACE**  
**TYPE / ID**

Secondary  
 Staff Unit  
 Preparation / Printing  
 Type 2 - HS602.09

**SCHEDULE AREA** 30m<sup>2</sup>



FIXTURES	
ID	QUANTITY
MSS-400B	6 Bays
SA400	1
CFL	1 (100L)

Floor Area shown 29.64 sq.m

FURNITURE	
ID	QUANTITY
B-21	1
B-26	1
B-53	1
Bo-20	1
C-04	1
D-05	1
M-91	1
S-14	1
SK-41	1
SW-401	1*
T-60	1
T-88	1

\* To be selected according to the user group characteristics. Selections to be confirmed by project control group

Furniture quantities are indicative and are related to the floor plan indicated. Actual furniture selection and quantities will be dependent on the approved design, specific school needs, student ages, student capabilities and their teachers.

1:100 @ A4 0 1 2 3 4m

**REVISION DATE**  
 12 DECEMBER 2013

The information on this sheet once printed/exported is classed as an uncontrolled copy.  
 The currency of the information should be checked by visiting the EFSG website prior to using the information for any purposes.