

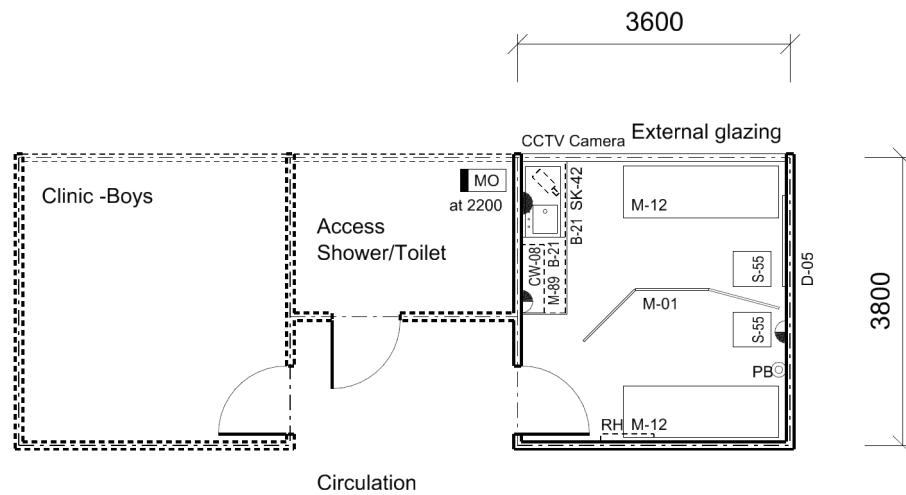

SCHOOL TYPE  
KEY LEARNING / SUPPORT AREA  
ROOM / SPACE  
TYPE / ID

Secondary  
Administration  
Clinic - Girls  
HS601.19

SCHEDULE AREA 13m<sup>2</sup>



Floor Area shown 12.95 sq.m

#### FIXTURES

ID

BLINDS TO WINDOWS

#### FURNITURE

ID	QUANTITY
B-21	2
CW-08	1
D-05	1
M-01	1
M-12	2
M-89	1
S-55	2
SK-42	1

Furniture quantities are indicative and are related to the floor plan indicated. Actual furniture selection and quantities will be dependent on the approved design, specific school needs, student ages, student capabilities and their teachers.

1:100 @ A4 0 1 2 3 4m

REVISION DATE  
12 DECEMBER 2013

The information on this sheet once printed/exported is classed as an uncontrolled copy.  
The currency of the information should be checked by visiting the EFSG website prior to using the information for any purposes.