



SCHOOL TYPE
KEY LEARNING / SUPPORT AREA
ROOM / SPACE
TYPE / ID

Secondary
Administration
Administration - Executive
Type 3 - HS601.16

SCHEDULE AREA 8m²

NOTES

- 1 Workstation dimensions critical depending upon room size/shape and position of windows/doors.

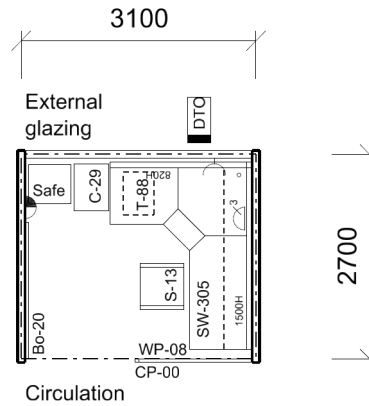

Floor Area 7.8 sq.m

FIXTURES

ID	QUANTITY
SAFE	1

FURNITURE

ID	QUANTITY
Bo-20	1
C-29	1
CP-00	1
S-13	1
SW-305	1*
T-88	1
WP-08	1

* To be selected according to the user group characteristics. Selections to be confirmed by project control group

Furniture quantities are indicative and are related to the floor plan indicated. Actual furniture selection and quantities will be dependent on the approved design, specific school needs, student ages, student capabilities and their teachers.

1:100 @ A4 0 1 2 3 4m

REVISION DATE
12 DECEMBER 2013

The information on this sheet once printed/exported is classed as an uncontrolled copy.
The currency of the information should be checked by visiting the EFSG website prior to using the information for any purposes.