

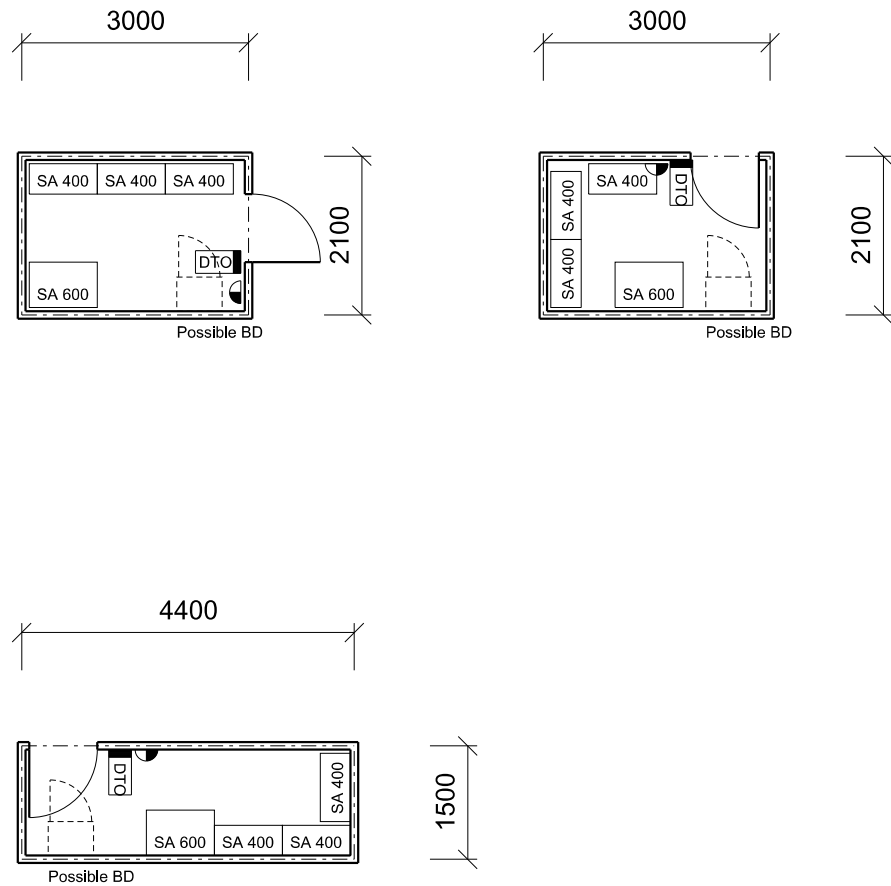

SCHOOL TYPE
KEY LEARNING / SUPPORT AREA
ROOM / SPACE
TYPE / ID

Secondary
Special Education Learning Unit (IO/IS/P)
GLS Store Room - Special Education
Type 2 - HS430.20

SCHEDULE AREA 6m²



FIXTURES	
ID	QUANTITY
SA400	3
SA600	1

Furniture quantities are indicative and are related to the floor plan indicated. Actual furniture selection and quantities will be dependent on the approved design, specific school needs, student ages, student capabilities and their teachers.

REVISION DATE
12 DECEMBER 2013

The information on this sheet once printed/exported is classed as an uncontrolled copy.
The currency of the information should be checked by visiting the EFSG website prior to using the information for any purposes.

1:100 @ A4 0 1 2 3 4m